

Model MLP Pear Link

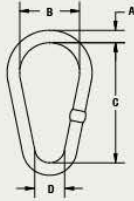

PRODUCT FEATURES:

- Welded construction.
- Heat Treated.
- Proof tested to 2:1 with certificate issued.
- Shot-blast finish with rust inhibitor.
- Serial number and capacity engraved on product
- Custom designs available.

SPECIFICATIONS

Model Number	Working Load Limit (lbs.)	Dimensions (Inches)				Weight (lbs.)
		A	B	C	D	
MLP-41-060	4,100	0.5	3	6	1.5	1
MLP-66-063	6,600	0.63	3	6	1.5	1.5
MLP-132-075	13,200	0.75	3	6	1.75	2.2
MLP-225-100	22,500	1	4	8	2.5	5.3
MLP-325-125	32,500	1.25	6	9	3	10
MLP-490-160	49,000	1.5	7	10.5	5.5	17
MLP-735-175	73,500	1.75	7	12	4	24
MLP-889-200	88,900	2	7	14	4	35

Model MLR Round Link

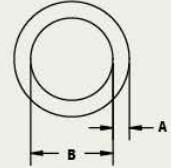

PRODUCT FEATURES:

- Welded construction.
- Heat Treated.
- Proof tested to 2:1 with certificate issued.
- Shot-blast finish with rust inhibitor.
- Serial number and capacity engraved on product
- Custom designs available.

SPECIFICATIONS

Model Number	Working Load Limit (lbs.)	Dimensions (Inches)		Weight (lbs.)
		A	B	
MLR-43-060	4,300	0.5	2.5	0.6
MPR-56-063	5,600	0.63	3	1
MLR-86-075	8,600	0.75	4	2
MLR-132-088	13,200	0.88	4	2.7
MLR-190-100	19,000	1	4	3.6
MLR-240-125	24,000	1.25	5	7
MLR-370-150	37,000	1.5	6	12
MLR-490-175	49,000	1.75	7	19
MLR-600-200	60,000	2	8	29

Model MLO Master Link

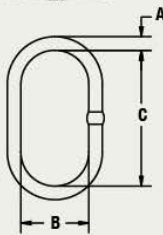

PRODUCT FEATURES:

- Welded construction.
- Heat Treated.
- Proof tested to 2:1 with certificate issued.
- Shot-blast finish with rust inhibitor.
- Serial number and capacity engraved on product.
- Custom designs available.

SPECIFICATIONS

Model Number	Working Load Limit (lbs.)	Dimensions (Inches)			Weight (lbs.)
		A	B	C	
MLO-36-041	3,600	0.41	1.50	3.00	1
MLO-50-050	5,000	0.50	2.50	5.00	1.3
MLO-61-063	6,100	0.63	3.00	6.00	1.8
MLO-160-075	15,000	0.75	2.75	5.50	2.0
MLO-225-100	22,500	1.00	3.50	7.00	6.1
MLO-325-125	32,500	1.25	4.38	8.75	12
MLO-490-160	49,000	1.50	5.25	10.50	19
MLO-735-175	73,500	1.75	6.00	12.00	26
MLO-889-200	88,900	2.00	7.00	14.00	37
MLO-1252-225	125,200	2.25	8.00	16.00	55
MLO-1473-250	147,300	2.50	8.00	16.00	69
MLO-1878-275	187,800	2.75	9.00	16.00	94

Model MLS Sub-Assembly

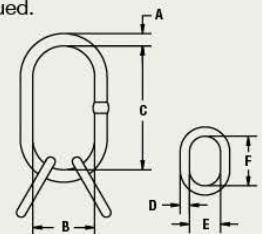

PRODUCT FEATURES:

- Heat Treated.
- Proof tested to 2:1 with certificate issued.
- Shot-blast finish with rust inhibitor.
- Serial number and capacity engraved on product.
- Custom designs available.

SPECIFICATIONS

Model Number	Working Load Limit (lbs.)	Dimensions (Inches)						Weight (lbs.)	
		A	B	C	D	E	F		
MLS-132-075/060	13,200	0.75	2.75	5.5	0.5	1.25	2	0.28	4
MLS-225-100/075	22,500	1	3.5	7	0.75	1.5	3	0.38	10
MLS-325-125/100	32,500	1.25	4.38	8.75	1	2	4	0.5	16
MLS-490-150/125	49,000	1.5	5.25	10.5	1.25	3	5.25	0.63	35
MLS-735-175/160	73,500	1.75	6	12	1.5	3.25	5.75	0.75	48
MLS-889-200/175	88,900	2	7	14	1.75	4	6	0.88	68
MLS-1252-225/188	125,200	2.25	8	16	1.88	4	7	1	132
MLS-1878-275/225	187,800	2.75	9	16	2.25	4.5	8	1.25	196